

**CRRU2 Forced turning**  
**Instruction & Maintenance Manual**  
**CRRU2 强制转弯安装使用维护手册**

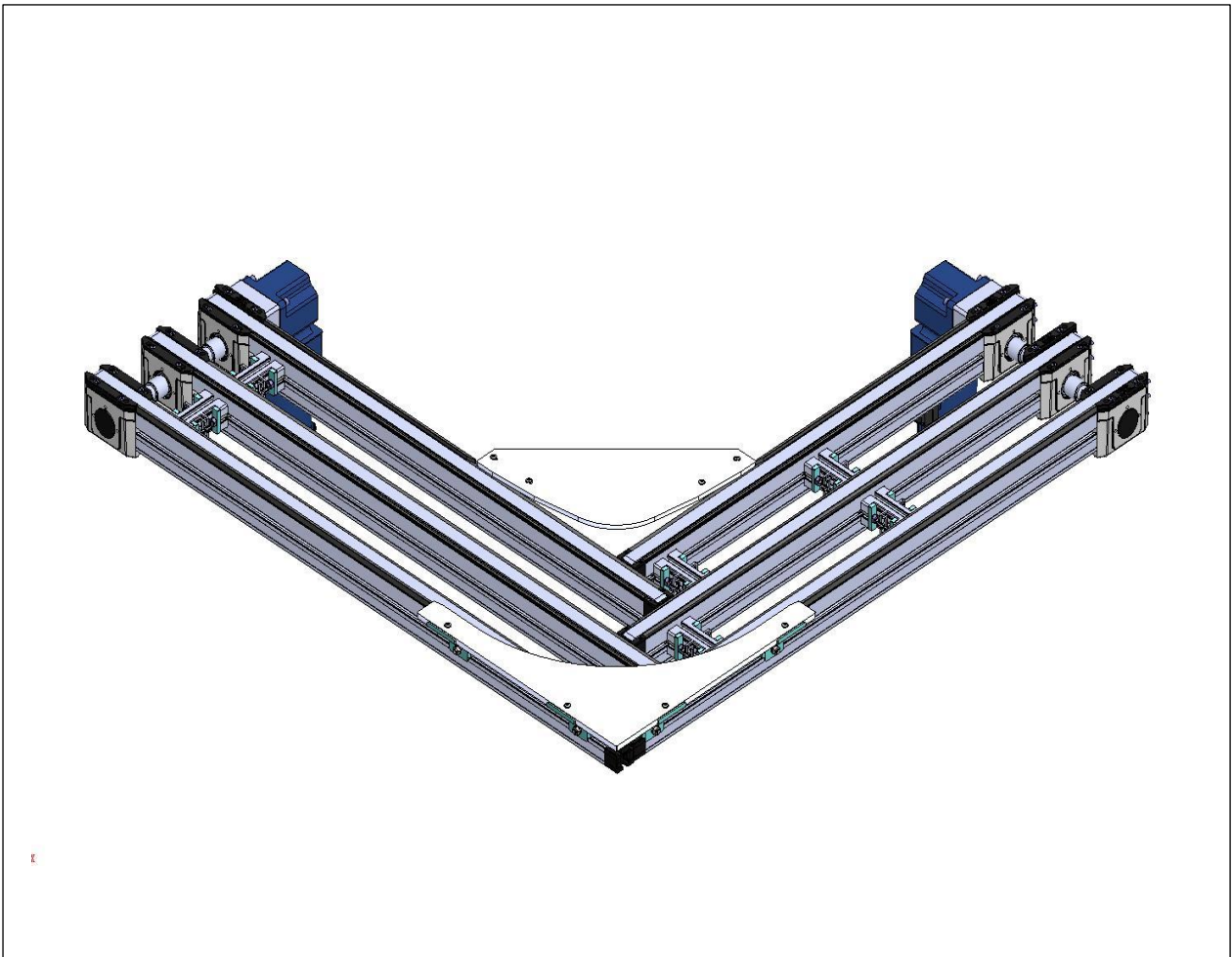

Suzhou LinkedGo Transfer System Co.,Ltd.

苏州领科工业技术有限公司

Structure Diagram 结构示意图

Drive unit  
驱动单元

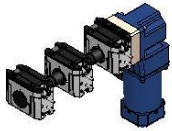

Intermediate conveying section  
中间输送段

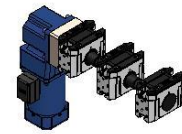
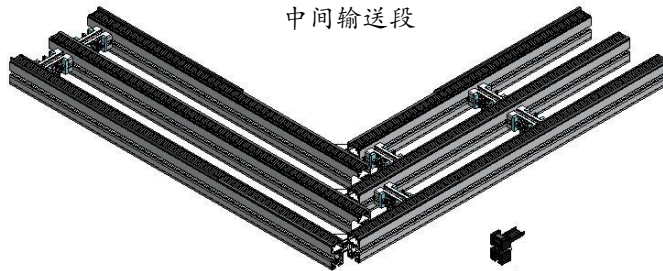

Drive unit  
驱动单元

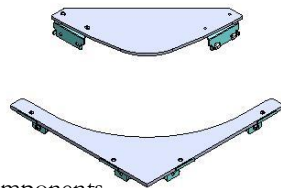

Turning components  
转弯组件

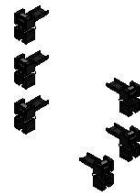

Return unit  
回转单元

产  
品  
特  
征

安  
装  
步  
骤

维  
护  
保  
养

- 1、 The length L of the straight section is 500-6000mm, and the width can be customized according to customer requirements.
- 1、 直线段长度 L 为 500-6000mm， 宽度可根据客户要求定制。
- 2、 The conveying medium is a toothed belt.
- 2、 输送介质为齿形皮带。
- 3、 The maximum load of the conveying section is 30kg.
- 3、 输送段最大负载为 30kg。
- 4、 Can run in reverse.
- 4、 可反向运行。
- 5、 The motor can be installed on the right, left, and middle of the line \* (\* when the conveying section width  $B \geq 240\text{mm}$ ).
- 5、 电机可安装在线体右侧、左侧和中间\* (\*当输送段宽度  $B \geq 240\text{mm}$ )。

Model Description 型号说明

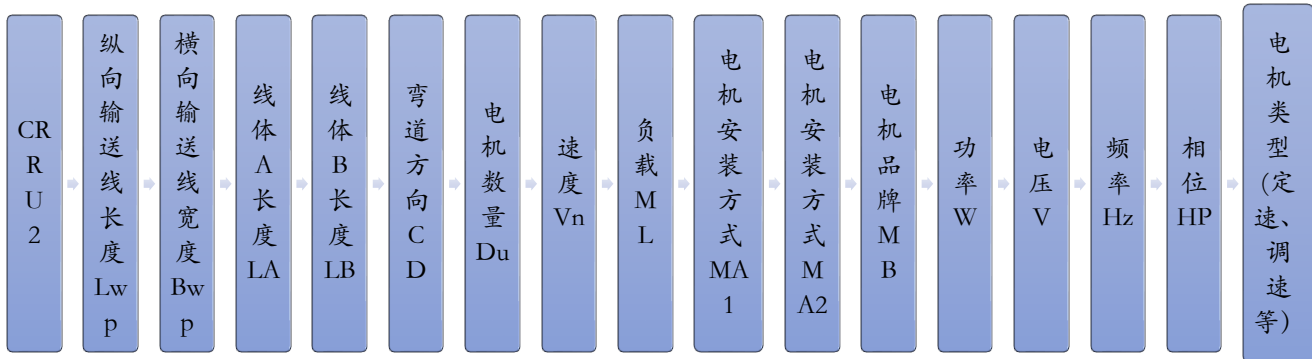

产品特征

例：CRRU 2/90-Bwp160-Lwp160-LA1045-LB565CDR-Du2-Vn18-ML15kg,MA1=R011A,MA2=R011A,MB=SEW-180W-220V-60Hz-3HP-C0-CR

安装步骤

The model CRRU 2/90-Bwp160-Lwp160-LA1045-LB565-CDR-Du2-Vn18-M, ML15kg,MA1=R011A,MA2=R011A,MB=SEW-180W-220V-60Hz- C0-CR representing a horizontal conveyor line with a width of 160mm, a vertical conveyor line with a length of 160mm, a line length of 1045mm, a line width of 565mm, and a bend direction to the right. There are two motors with a running speed of 18m/min and a running load of 15kg. The motor installation position is R011A, the motor brand is SEW, the power is 180W, the voltage is 220V, the frequency is 60Hz, and the phase is 3. It is a fixed speed motor.

型号 CRRU 2/90-Bwp160-Lwp160-LA1045-LB565-CDR-Du2-Vn18-ML15kg,MA1=R011A,MA2=R011A,MB=SEW-180W-220V-60Hz- C0-CR, 表示横向输送线体宽度 160mm, 纵向输送线长度 160mm, 线体 A 长度 1045mm, 线体 B 长度 565mm, 弯道方向向右, 有两个电机, 运行速度 18m/min, 运行负载 15kg, 电机安装位置为 R011A, 电机品牌为 SEW, 功率为 180W, 电压为 220V, 频率为 60Hz, 相位为 3 的定速电机。

维护保养

安装步骤 Installation steps

A Install the middle conveying section.

A 安装中间输送段。

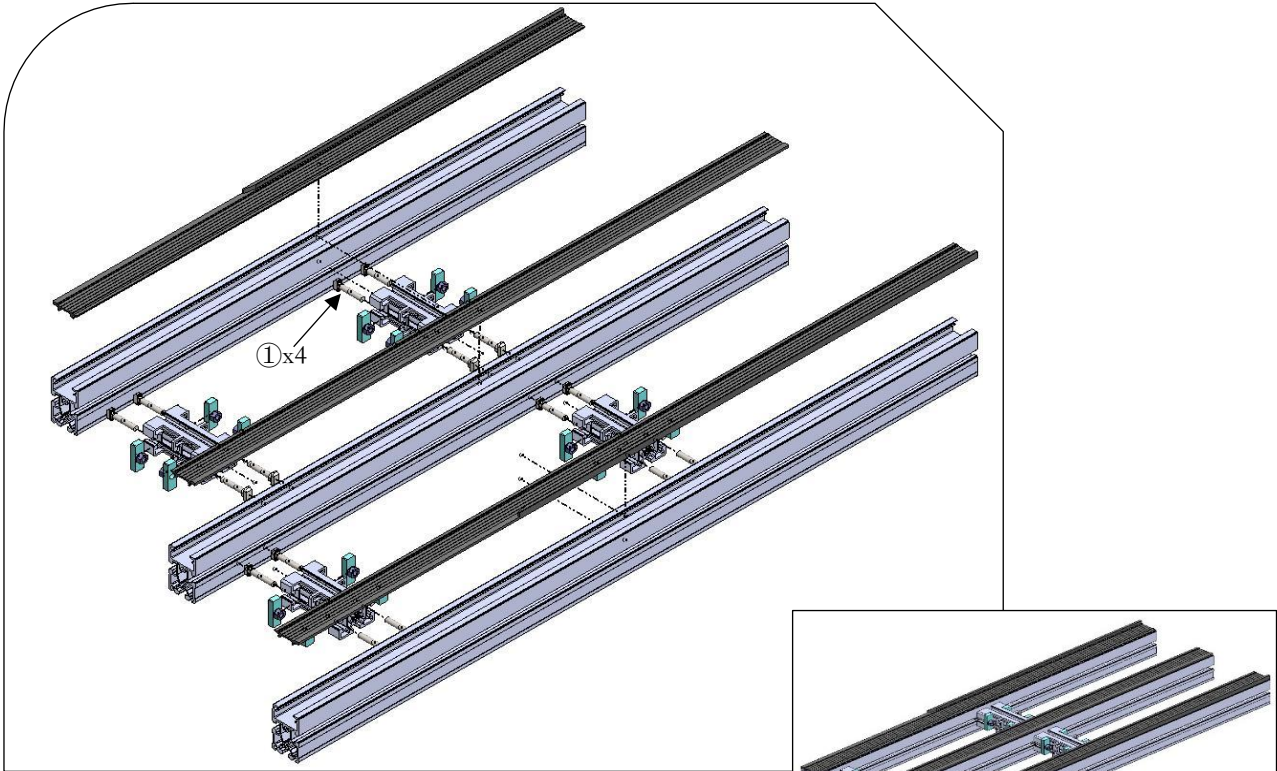

① — { 10-8-40  
5 5Nm

B Install the front and rear covers.

B 安装机头、机尾外罩。

Installing the driver head

安装驱动头

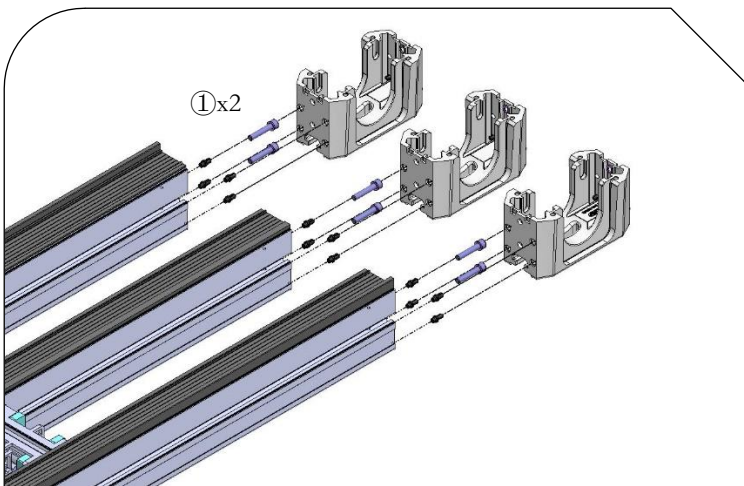

① — { M6x30  
6 8Nm

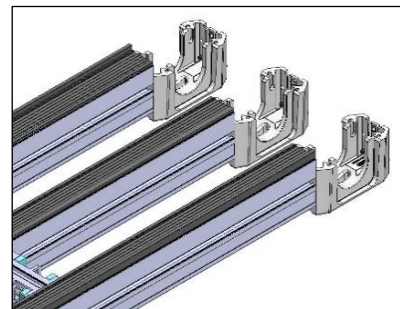

Install the pulley  
安装带轮

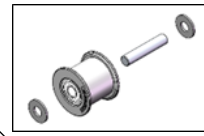
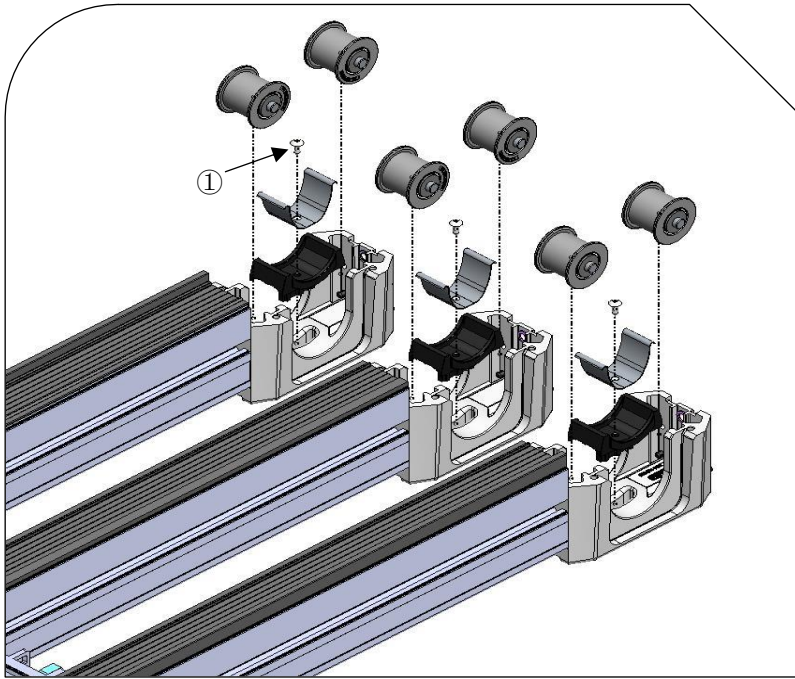

① — ST4.2x14L  
6 8Nm

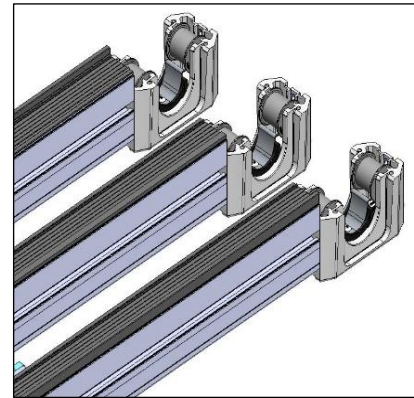

产  
品  
特  
征

安  
装  
步  
骤

Installing the tail of the aircraft  
安装机尾

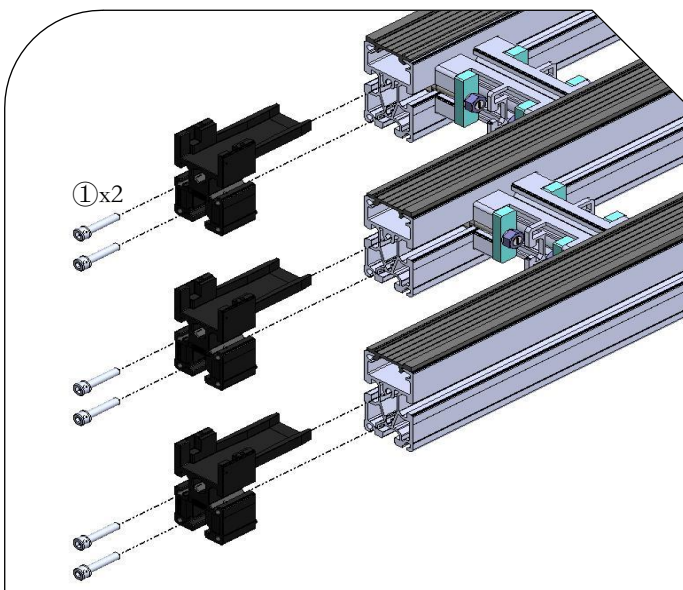

① — M6x30  
6 8Nm

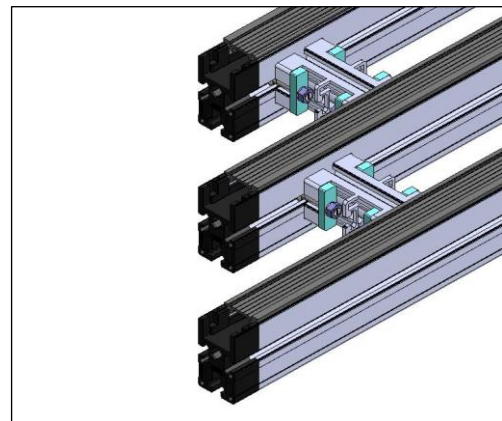

维  
护  
保  
养

C Assembling the main body.

C 组装主线体

Assembly of T-shaped bearing seat assembly

组装 T 字型轴承座位组件

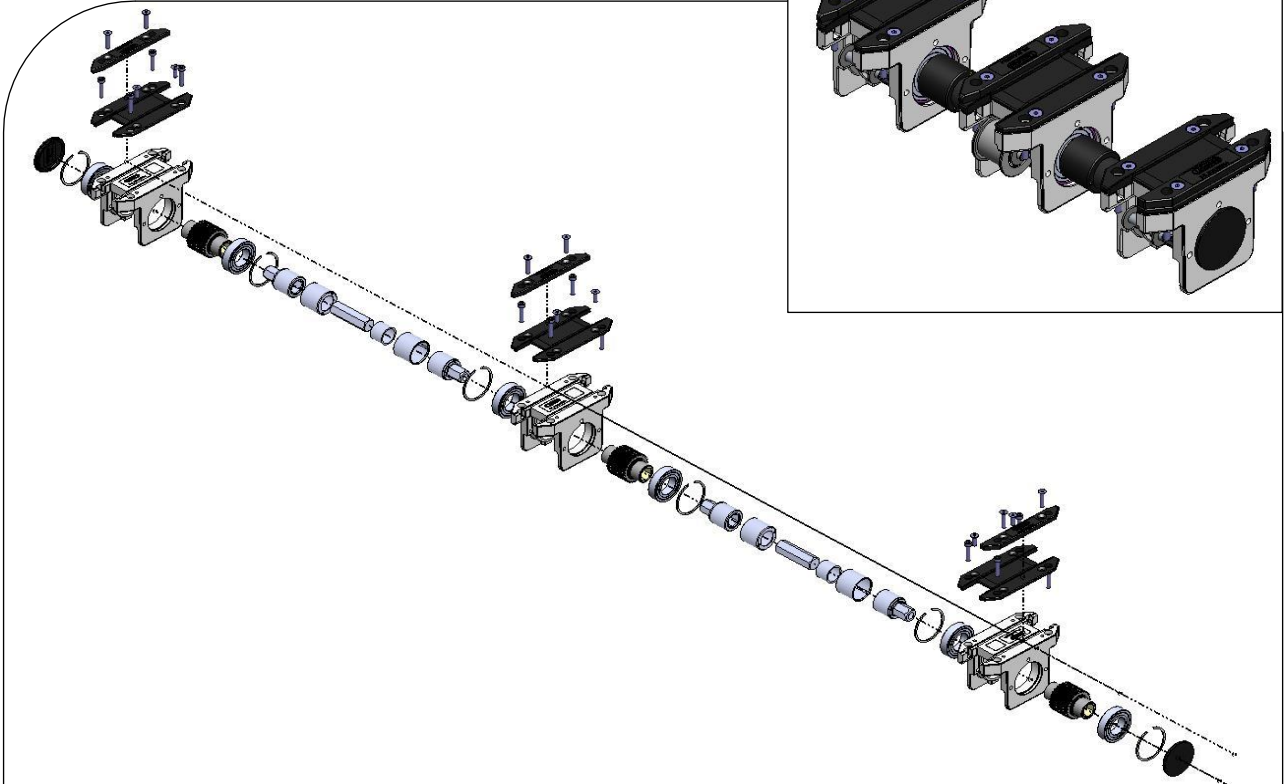

Pulley pre installation

滑轮预装

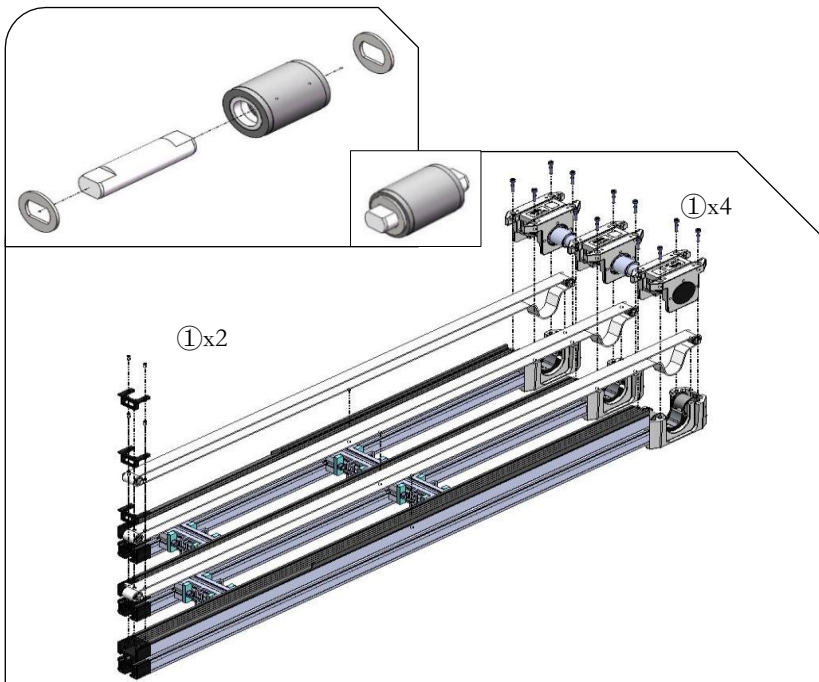

① — M5x25  
① — 8Nm

② — ST3x16  
② — 6 8Nm

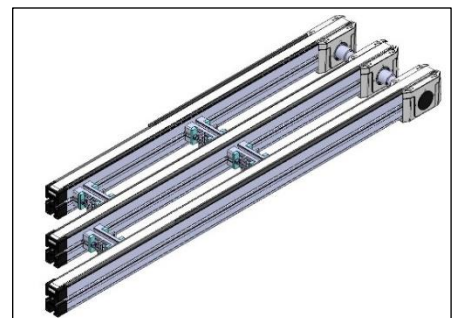

产  
品  
特  
征

安  
装  
步  
骤

维  
护  
保  
养

产品特征

安装步骤

维护保养

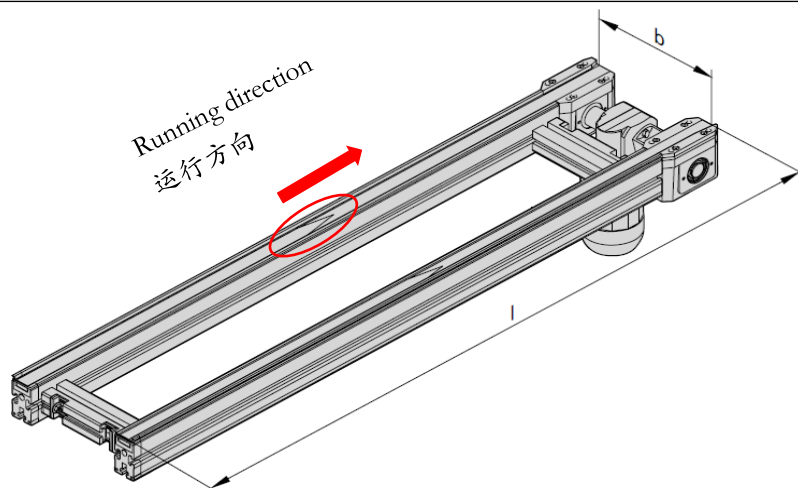

Note:

When installing the belt, the direction of the belt connection should be consistent with the direction of the line operation.

请注意:

安装皮带时，皮带接驳朝向应与线体运行方向保持一致。

D Installation of 90 ° Corner Assembly.

D 安装 90° 转角组件。

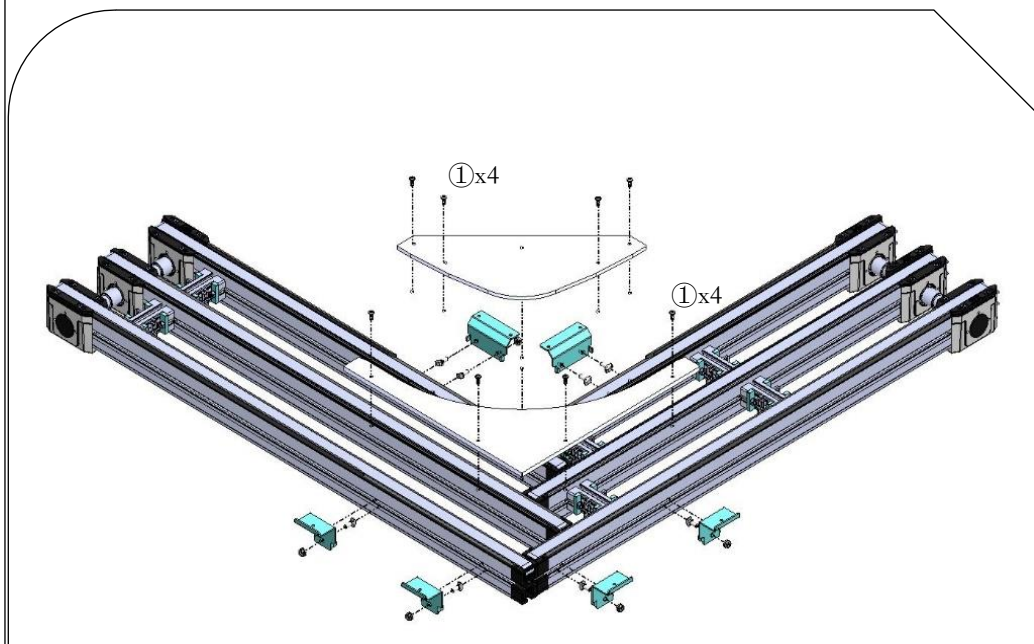

E Installing the motor.

E 安装电机

Attention:

注意:

1. The motor should be installed firmly and not tilted.
- 1、电机安装稳固不能倾斜。
2. The direction of the motor and junction box must meet the technical requirements.
- 2、电机与接线盒方向必须符合技术要求。

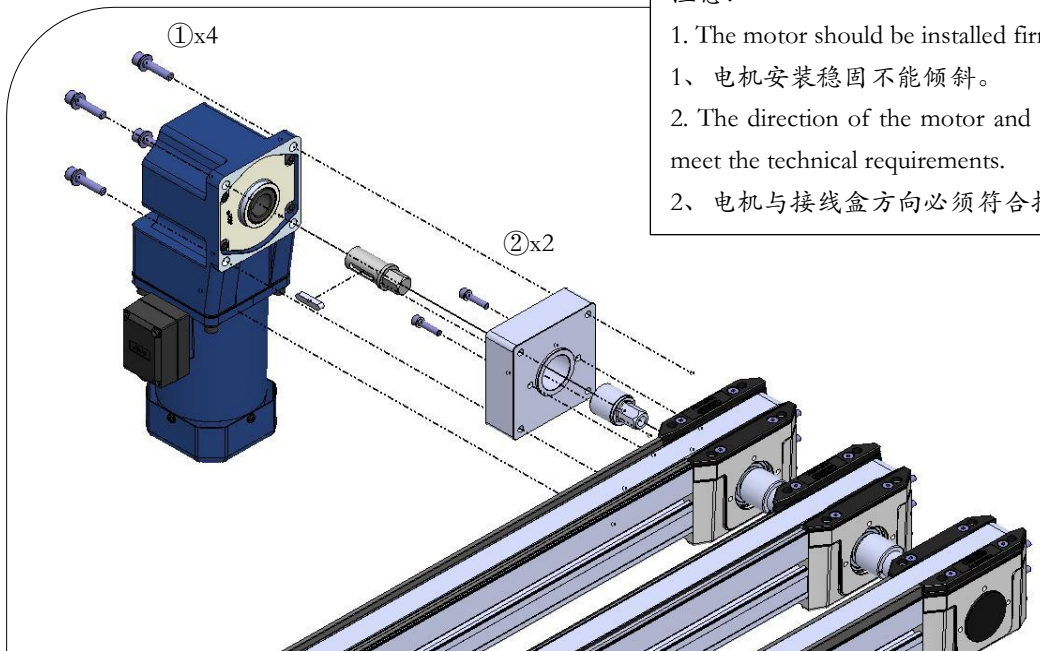

- ① — M8x35
- ① — ⑥ 13Nm
- ② — M6x25
- ② — ⑤ 6Nm

Maintenance 维护和保养

产  
品  
特  
征

The UTS series tray conveying system requires regular maintenance and upkeep to extend the service life of the line. The conveying equipment should be kept clean to avoid direct sunlight or rain or snow, and to prevent contact with substances such as acids, alkalis, oils, organic solvents, etc.

UTS 系列托盘输送系统需按周期进行规定的保养维护工作，以延长线体使用寿命。输送设备应保持清洁避免阳光直射或雨雪浸淋，防止与酸、碱、油类、有机溶剂等物质接触。维护前需关闭对应的能源供给。

安  
装  
步  
骤

Daily Maintenance  
日维护

Regularly clean the conveyor line. Before starting the machine every day, it is necessary to clean the floating dust, falling small parts, and other obstacles on the belt and wire body to prevent dust and dirt from affecting the operation of the wire body. When cleaning the machine head, it is necessary to remove the upper cover of the machine head, pick up the T-shaped bearing seat, and use an air gun to remove the accumulated dust inside. During trial operation, check whether there are any abnormalities in various parts of the conveyor line, such as loose bearings or abnormal noise. Once any abnormalities are found, repair and replace them immediately. Check the belt daily for burrs, stretching deformation, tearing, wire breakage, wear, and looseness, and make timely adjustments, repairs, or replacements.

定期清洁输送线。每日开机前需清理皮带及线体上的浮尘、掉落的小零件及其他障碍物，防止积尘和污垢影响线体运行。在清洁机头时，需拆掉机头上盖，拿起T型轴承座，用气枪清除里面积压的灰尘。试运行，检查输送线的各部位是否有异常，如轴承有无松动或异常噪音，一旦发现异常应即使维修和更换。每日检查皮带是否有毛边、拉伸变形、撕裂断丝、磨损和松动等情况，及时调整维修或更换。

维  
护  
保  
养

Weekly Maintenance  
周维护

Regularly inspect the accessories on the conveyor line body. For parts that are prone to damage such as synchronous wheels, bearings, and idlers, regular inspection, maintenance, and lubrication are required. If damage or looseness is found, it must be replaced immediately. Check if the fasteners on the wire body are loose and tighten them in a timely manner.

定期检查输送线体上的附件。对于同步轮、轴承、惰轮等容易损坏的零件，需定期检查、保养和润滑。发现损坏和松动须立即更换。检查线体上的紧固件是否有松动情况，及时紧固。

Monthly Maintenance  
月维护

Regularly clean motor bearings, check for wear, and replace lubricating oil in a timely manner. (It is necessary to replenish the oil at any time based on the on-site operating conditions and the degree of oil volatilization. Under normal operation, the lubricating oil can be replaced every six months.)

对于电机轴承等定期清洗，检查磨损情况，及时更换润滑油。(需根据现场运行状况及油脂挥

发程度进行随时补油，正常运行下，可六个月更换一次润滑油。)

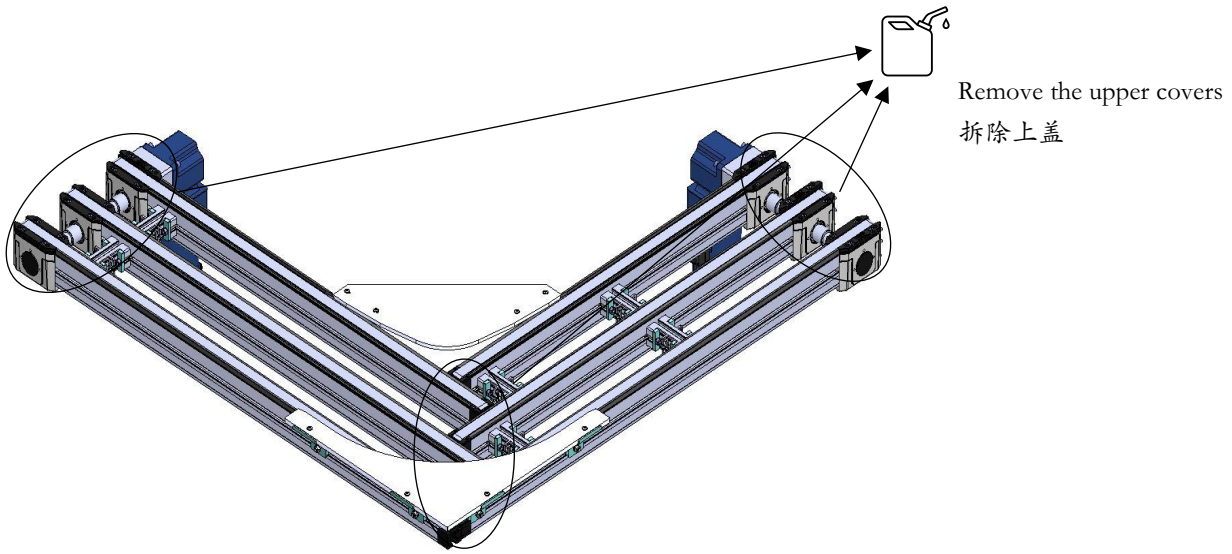

产  
品  
特  
征

安  
装  
步  
骤

Quarterly Maintenance

季度维护

Check the wear of bearings, idlers, pulleys, and synchronous wheels, and replace them in a timely manner. Check if the toothed belt is loose or deformed, and if the friction strip is severely worn, and replace it in a timely manner. Confirm that the operation is in good condition, without any belt jamming, slipping, deviation, or abnormal noise from the wire body. If this situation occurs, it is necessary to check whether the internal structure of the drive unit and rotary unit is intact.

检查轴承、惰轮、滑轮、同步轮的磨损情况，及时更换。检查齿形带是否松弛变形，磨擦条是否磨损严重，并及时更换。确定运行状况良好，无皮带卡顿、打滑、偏移及线体异响的情况发生，如有此情况，需检查驱动单元、回转单元是否内部结构完好。

维  
护  
保  
养

Disclaimer

免责声明

The customer shall inspect the equipment regularly. If the customer fails to maintain the conveyor as the state above, leading to any malfunction or damage to the conveyor, our company will not be responsible for it, all related costs (including material costs, installation and commissioning fees, and hotel expense) shall be borne by the customer.

客户应定期对设备进行检查。若客户未按要求对输送机进行维护，进而导致输送机发生任何故障或损坏，我司将不承担相关责任，由此产生的相关费用（材料费，安装调试费，差旅费）均由客户承担。

Suzhou LinkedGo Transfer System Co.,Ltd.  
苏州领科工业技术有限公司

[Tel: +86-512-6636 1885](tel:+86-512-66361885)

Add: Room 706, Building D, Dongchuang Science and Technology Park,  
No. 216 Jinfeng Road, Wuzhong District, Suzhou, P.R. China

Zip code:215101

E-mail: [Sales@LinkedGo.com.cn](mailto:Sales@LinkedGo.com.cn)

Website: [www. LinkedGo.com.cn](http://www.LinkedGo.com.cn)

Subject to technical modifications

电话: +86-512-6636 1885

地址: 苏州市吴中区木渎镇金枫路 216 号东创科技园 D 幢 706 室

邮编: 215101

邮箱: [Sales@LinkedGo.com.cn](mailto:Sales@LinkedGo.com.cn)

网址: [www.LinkedGo.com.cn](http://www.LinkedGo.com.cn)

我司保留技术更改的权利